



TEXAS GENERAL LAND OFFICE
COMMISSIONER DAWN BUCKINGHAM, M.D.

May 26, 2026

Galveston County
722 Moody Ave
Galveston, TX 77550-2317

RE: Renewal of Coastal Lease No. CL20070008
Galveston Bay, Chambers County, Texas

Dear Lessee:

According to our records, the above-referenced Coastal Lease from the School Land Board for the use of Coastal Public Land owned by the Permanent School Fund has an expiration date of **July 31, 2022**.

Please complete the enclosed application and affidavit and return them to the Texas General Land Office, to the address or email address below, within twenty (20) days of receipt of this letter. Also enclosed is the drawing from your most recent contract. If you would like to make modifications and/or additions to the permitted structure, please indicate those changes on the drawing and return it with the application and affidavit. **You do not need to send any money at this time.**

Your Coastal Lease will be reviewed and an on-site inspection may be conducted to determine compliance with the current contract.

Please note that placement of unauthorized structures and/or failure to obtain the required authorization from this office for the use of Coastal Public Land may subject the responsible party to civil penalties and/or removal of unauthorized structures by the State with recovery of removal costs from the responsible party or placement of a lien against the adjacent littoral property (Texas Natural Resources Code, Sections 33.112, 51.302, and 51.3021). Mitigation costs may also be assessed when necessary to compensate for damage to natural resources.

If you have any questions, please contact me at pantelia.spetsiotis@glo.texas.gov or (281) 471-0391 x118.

Sincerely,

A handwritten signature in black ink that reads "Pantelia Spetsiotis".

Pantelia Spetsiotis
Coastal Land Specialist

Enclosures

STATE OF TEXAS



GENERAL LAND OFFICE
APPLICATION FOR RENEWAL OF COASTAL LEASE

GLO ID: CL20070008 Expiration Date: July 31, 2022

Please type or print in the blanks below all applicable information. If information requested is not applicable, indicate by placing N/A in the blank. ISSUANCE OF THE COASTAL LEASE FOR WHICH YOU HAVE APPLIED IS CONTINGENT UPON VERIFICATION OF THE INFORMATION SUBMITTED, PAYMENT OF APPROPRIATE FEES, AND COMPLIANCE WITH ALL APPLICABLE REGULATORY REQUIREMENTS.

I. Applicant Information (Responsible Party Under Contract):

A. Name: Galveston County
Mailing Address: 722 Moody Ave
City/State/Zip: Galveston, TX 77550-2317
Telephone: Home: Work: (409) 770-5399
Cell Phone: Fax: (888) 534-5607
Email Address: mike.fitzgerald@co.galveston.tx.us

B. Please list any changes/corrections to demographic information above in the spaces provided below if applicable:

Name: Galveston County
Mailing Address: 4102 Main Street
City/State/Zip: La Marque, TX 77568
Telephone: Home: Work: 409-934-8101
Cell Phone: Fax: 409-621-7986
Email Address: martha.lee@co.galveston.tx.us

II. Signature of Applicant(s): Galveston County

By: [Signature]
Signature
Mark Henry
Printed Name

County Judge
Title
June 22, 2026
Date

Information collected by electronic mail and by web form is subject to the Public Information Act, Chapter 552, Government Code.

STATE OF TEXAS

§
§
§

COUNTY OF CHAMBERS

COASTAL LEASE RENEWAL AFFIDAVIT

The undersigned being first duly sworn on oath, states as follows:

1. The undersigned is the grantee under Coastal Lease No. CL20070008 (the "CL");
2. The undersigned has applied to the General Land Office (the "GLO") to renew the CL for an additional term;
3. The undersigned has complied with all of the terms of the CL during its term and has complied with all of the guidelines and rules of the GLO and the School Land Board (the "SLB") applicable to the CL;
4. The undersigned has not made any improvements, additions, or modifications to the Premises, as shown on the exhibit, attached hereto and incorporated herein by reference, during the term of the CL, without the advance written consent of the GLO; and
5. The undersigned acknowledges that the SLB and the GLO will rely on the truth of the statements contained herein in issuing the renewal of the CL. In the event that any of the statements herein prove to be untrue, the renewal CL shall be subject to immediate termination, which will require that the undersigned remove all structures from the Premises.

GRANTEE: Galveston County

By: [Signature]
 Signature
Mark Henry, County Judge
 Printed Name

June 22, 2026
 Date
 Attest: [Signature]
 Dwight Sullivan
 County Clerk

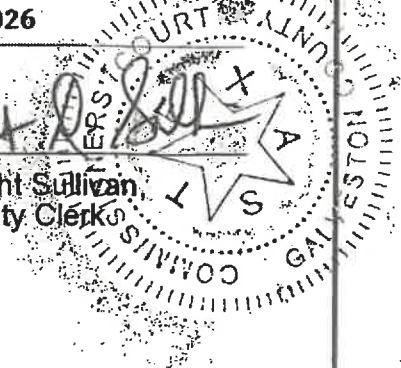

ACKNOWLEDGMENT

STATE OF TEXAS §
 COUNTY OF GALVESTON §

This instrument was acknowledged before me on the 22ND day of JUNE, 2026,
 by MARK HENRY for Galveston County.

[Signature]
 (Notary Signature)
 Notary Public, State of TEXAS
 My commission expires: 02-11-2027

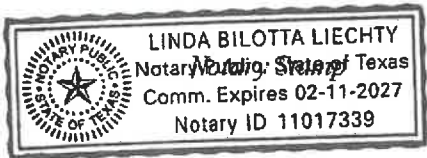

Information collected by electronic mail and by web form is subject to the Public Information Act, Chapter 552, Government Code.

**TEXAS GENERAL LAND OFFICE
APPLICATION FOR RENEWAL OF COASTAL LEASE**

NOTES:

1. The application will be reviewed by the GLO Field Office to verify site conditions. Lessee will be advised regarding term length, special conditions, and payment amounts. It will then be submitted to the Texas School Land Board (SLB) for consideration. If approved by SLB, a contract will be prepared and sent to Lessee for signatures.
2. Lessee is advised that in accordance with the easement agreement, unless renewed on a timely basis, hold-over occupancy beyond the expiration date of the easement is subject to increased lease payment amounts.
3. Lessee is advised that in accordance with provisions of the easement agreement, if the agreement is not renewed, all private property and man-made improvements must be removed and the premises returned to pre-easement conditions within 120 days of the expiration date.

PLEASE ANSWER THE QUESTIONS BELOW



**Galveston Bay
Chambers County
State Tract 304**

DOES THE EXISTING STRUCTURE REMAIN THE SAME AS PREVIOUSLY AUTHORIZED IN THIS DRAWING?

YES OR NO

IF NO, USE THIS DRAWING TO SHOW WHAT HAS CHANGED

ARE YOU PROPOSING ANY CHANGES TO THE PROJECT AT THIS TIME?

YES OR **NO**

IF YES, USE THIS DRAWING TO SHOW THE PROPOSED MODIFICATIONS.

SIGNATURE: *Mark Henry* TITLE: County Judge

PRINTED NAME: Mark Henry DATE: 6/22/2026

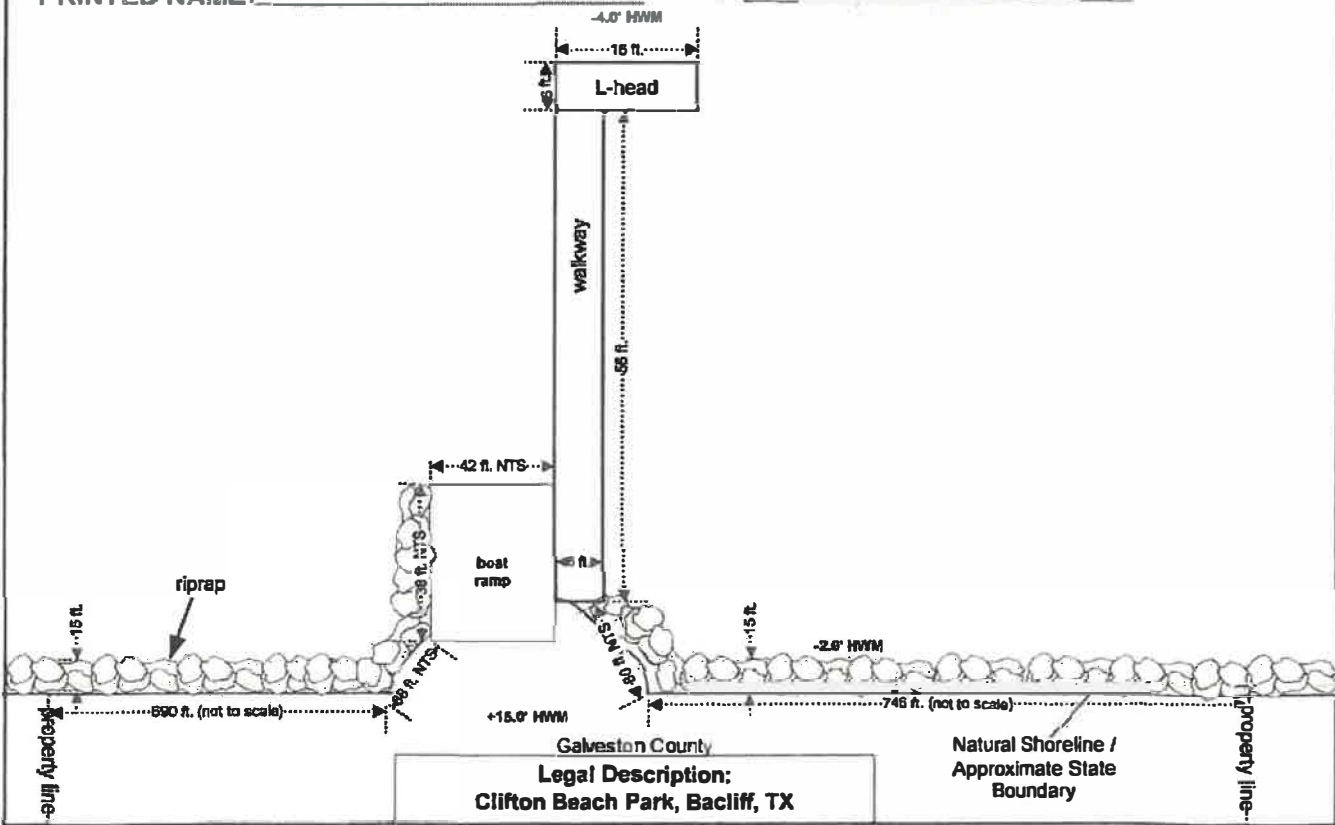

Title: Galveston County-- CL20070008	Date of Inspection: 03/23/2012
Scale: 1 inch equals 20 feet (NTS= Not To Scale)	Created by: Steven Mitchell Modified by: AWilcox
Texas General Land Office	Attachment B



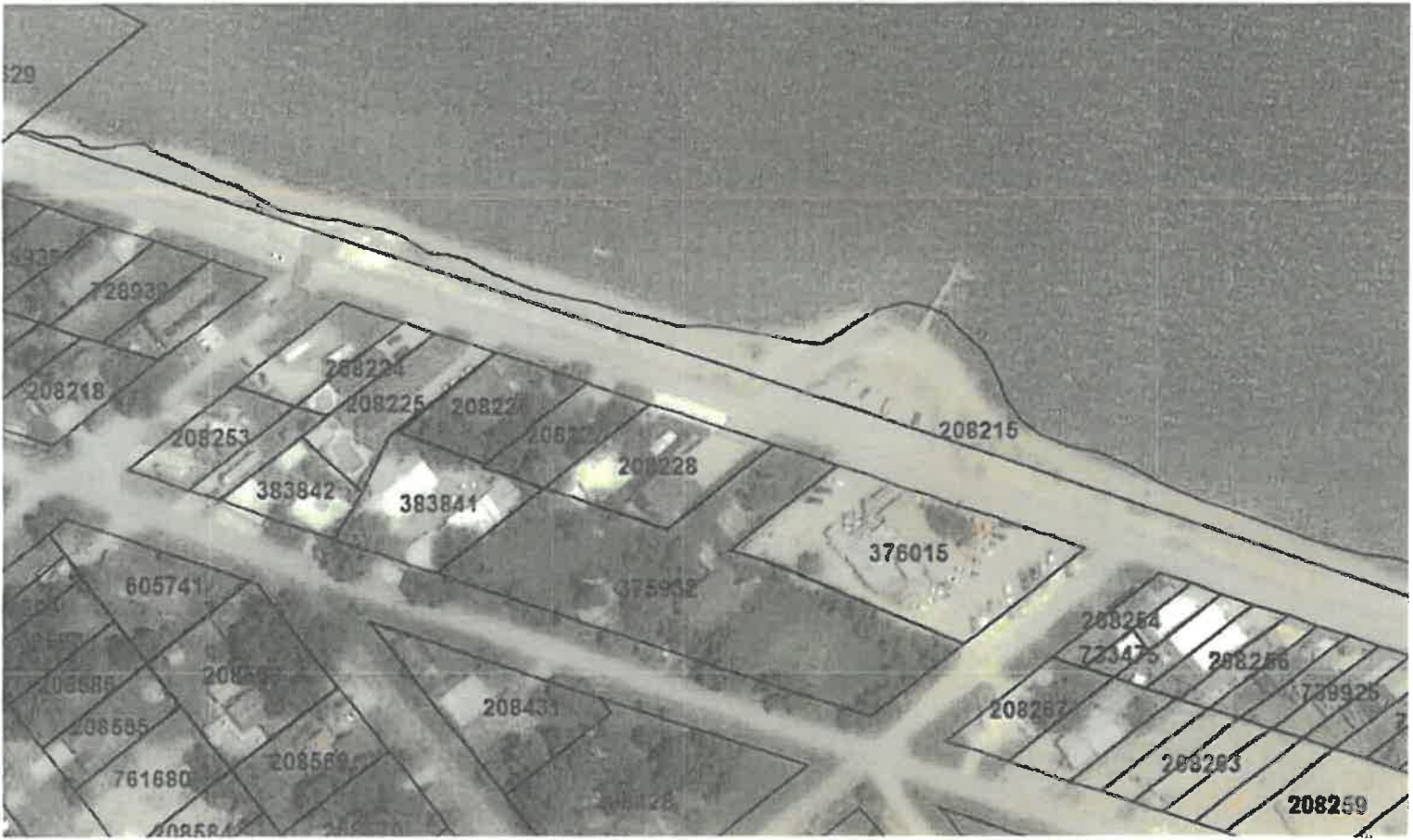

29

728938

208218

208224

208225

208226

208227

208253

208228

208215

383842

208228

383844

376015

605741

375932

208254

733475

208256

208585

208586

739926

208585

208433

208257

761680

208589

208253

208589

208428

208259