

**MEMORANDUM OF UNDERSTANDING BETWEEN
GALVESTON COUNTY AND
UTMB CORRECTIONAL MANAGED CARE**

This Memorandum of Understanding ("MOU") is between Galveston County ("GC") and The University of Texas Medical Branch at Galveston ("UTMB"): The Department of Correctional Managed Care ("CMC").

Recitals

WHEREAS GC has a need for healthcare services for their inmate population housed in the jail system and has agreed to lease space to CMC for CMC to provide the needed healthcare services

WHEREAS CMC's has agreed to provide healthcare services at two locations: the Galveston County Adult Correctional Facility clinic and the Juvenile Detention Center

NOW THEREFORE, in consideration of the foregoing recitals and in consideration of the mutual benefits, the parties agree as follow:

Locations where healthcare Services are to be rendered:

- Galveston County Jail located at 5700 Avenue H, Galveston, Texas 77551
- Galveston County Juvenile Justice Department at 6101 Attwater Ave, Texas 77590

GC shall lease to CMC:

The leased space consists of approximately 6,600 square feet located in the Galveston County Jail located at 5700 Avenue H, Galveston, Texas 77551 as designated on Exhibit "A" and approximately 358 square feet located in the Galveston County Juvenile Justice Department at 6101 Attwater Ave, Texas 77590 as designated on Exhibit "B".

CMC's Permitted Use:

CMC shall use the leased space to provide the inmate population medical, primary care or other health care services, including, without limitation, medical examination and treatment, cancer treatment and counseling, medical consultations, imaging (e.g., mammography, radiology, ultrasounds, MRI, PET scans, CT scans, and x-rays), and surgery or other medical procedures, telemedicine and teleradiology services.

Lease Cost:

GC shall charge no rent for the leased space.

Terms:

- A. The term of this MOU commences on August 1, 2025, and shall remain in effect through August 31, 2030.
- B. Either party may terminate this MOU by providing the other party with thirty (30) days written notice.

Correctional Managed Care

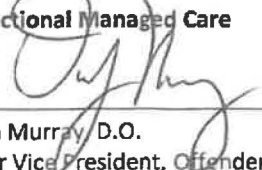
Owen Murray, D.O. Date
Senior Vice President, Offender Health Services

6/30/25

Galveston County Jail

Jimmy Fullen
Sheriff

Date

7-7-25

Galveston County Juvenile Justice Department

Judge Mark Henry
Galveston County Judge

July 7, 2025
Date

EXHIBIT A

KEY:
Yellow = medical office space, clinics and/or triage rooms
Red = designated medical cells
Blue = medical housing units

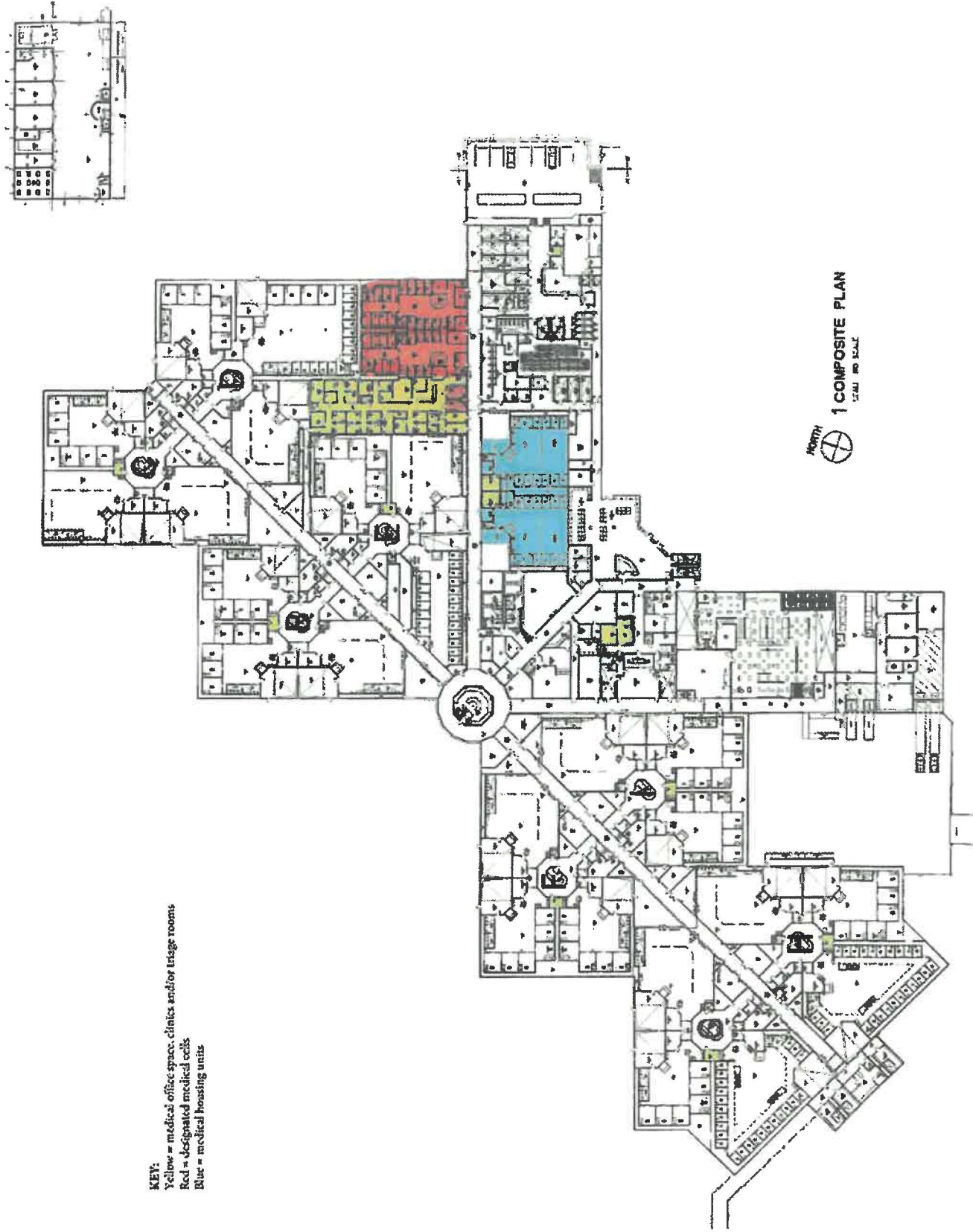

This is a detailed architectural floor plan of a large, multi-story building. The plan is oriented vertically on the page. It features a complex arrangement of rooms, corridors, and a central courtyard area. A red rectangular box highlights a specific section of the plan, possibly indicating a point of interest or a specific area of study. The drawing is oriented vertically on the page.

RECEIVED: 44) FOR DESCRIPTION OF ENLARGED PLAN DETAILS

WARRY A. GOLESON, F.A.I.A.
601 JEFFERSON, SUITE 950
HOUSTON, TEXAS 77002

**GALVESTON COUNTY
JUVENILE JUSTICE CENTER
TEXAS CITY, TEXAS**

FLOOR PLAN

A2.1

9301, 2324